

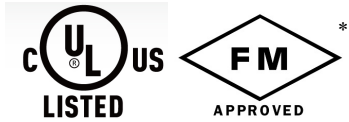

# NATIONAL FIRE EQUIPMENT LTD.

SERVICE, SOLUTIONS, INNOVATION

## RISER CLAMPS

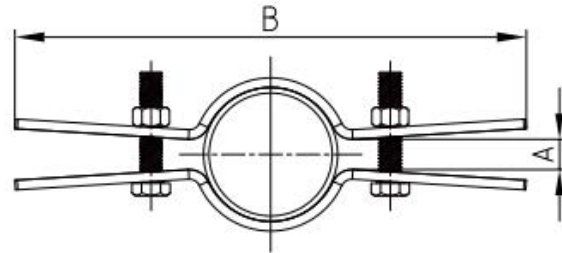

- **Function:** Designed for supporting vertical pipes.
- **Material:** Carbon steel
- **Finish:** Electro-galvanized (Hot-Dip Galvanized with electro-galvanized hardware upon request)
- **Approvals:** Underwriters' Laboratories Listed in the U.S. (UL), Canada (CUL), for use with standard steel pipe sizes 1/2" to 12". Factory Mutual Approved for steel pipe sizes 3/4" to 12". Complies with Manufacturers' Standardization Society ANSI/MSS SP-58 (Type 8) which supersedes ANSI/MSS SP-69.
- **Maximum Temperature:** 343° C (650° F)

Item	Size	Kurlid Insert Nut		A	B	Max. Rec. Load		
		mm	in			Lbs	Kg	N
	1/2"	M10	3/8"-16UNC	10.5	223	299	135	1334
	3/4"	M10	3/8"-16UNC	12.1	229	299	135	1334
3620	1"	M10	3/8"-16UNC	12.2	235	299	135	1334
3621	1-1/4"	M10	3/8"-16UNC	12.2	244	299	135	1334
3622	1-1/2"	M10	3/8"-16UNC	12.3	250	299	135	1334
3623	2"	M12	1/2"-13UNC	15.3	262	299	135	1334
3624	2-1/2"	M12	1/2"-13UNC	16	278	339	153	1512
3625	3"	M12	1/2"-13UNC	18.9	291	419	189	1868
	3-1/2"	M12	1/2"-13UNC	19.6	313	499	225	2224
3626	4"	M12	1/2"-13UNC	19.3	326	599	270	2668
	5"	M12	1/2"-13UNC	20.3	362	799	360	3558
3627	6"	M12	1/2"-13UNC	23.3	390	1059	477	4714
3628	8"	M16	5/8"-11UNC	19.1	461	1619	729	7205
3629	10"	M16	5/8"-11UNC	19	515	2339	1053	10408
3630	12"	M16	5/8"-11UNC	18.9	566	3159	1422	14055

\* UL/ULC Listed FM Approved under Jinan Meide Casting CO. LTD model EGSC9